

Model: Adonis-C2 PT1045		Date: 14-Sep-01	No.: MB376001
Modified Article: Left Guide Plate - Middle		Prepared by: E. Fukuyama	
From: Technical Services Dept., GTS Division			
Reason for Modification:	<input type="checkbox"/> Parts catalog correction <input type="checkbox"/> To facilitate assembly <input type="checkbox"/> Part standardization	<input type="checkbox"/> Vendor change <input checked="" type="checkbox"/> To improve reliability <input type="checkbox"/> Other	<input type="checkbox"/> To meet standards (      )

To further ensure that the Middle Left Guide Plate stays securely attached, the width of the boss has been increased from 6 mm to 9 mm.

Old part number	New part number	Description	Q'ty	Int	Page	Index	Note
A6842211	B3762211	Left Guide Plate - Middle	1-1	X/O	5	20	

## RCL (Japan) Production

MODEL NAME	DESTINATION	CODE	SERIAL NO.
1 – BIN TRAY	USA, Canada, Europe, Asia	B376-17	H7810500001
1 – BIN TRAY	USA, Canada, Europe, Asia	B376-14	L08441050001
1 – BIN TRAY	USA, Canada, Europe, Asia	B376-26	4J70510001

Model: Adonis-C2 PT1045		Date: 20-Mar-02	No.: MB376002
Modified Article: Upper Right Cover and Mylar		Prepared by: E. Fukuyama	
From: Technical Services Dept., GTS Division			
Reason for Modification:	<input type="checkbox"/> Parts catalog correction	<input type="checkbox"/> Vendor change	<input type="checkbox"/> To meet standards ( )
	<input type="checkbox"/> To facilitate assembly	<input checked="" type="checkbox"/> To improve reliability	
	<input type="checkbox"/> Part standardization	<input type="checkbox"/> Other	

To further ensure smooth paper transport and avoid paper jams, the shape of the Upper Right Cover has been changed and a Mylar has been added.

Old part number	New part number	Description	Q'ty	Int	Page	Index
B3761551	B3761552	Upper Right Cover	1-1	X/O	3	2
-	B3761556	Paper Guide Mylar	0-1	-	3	34

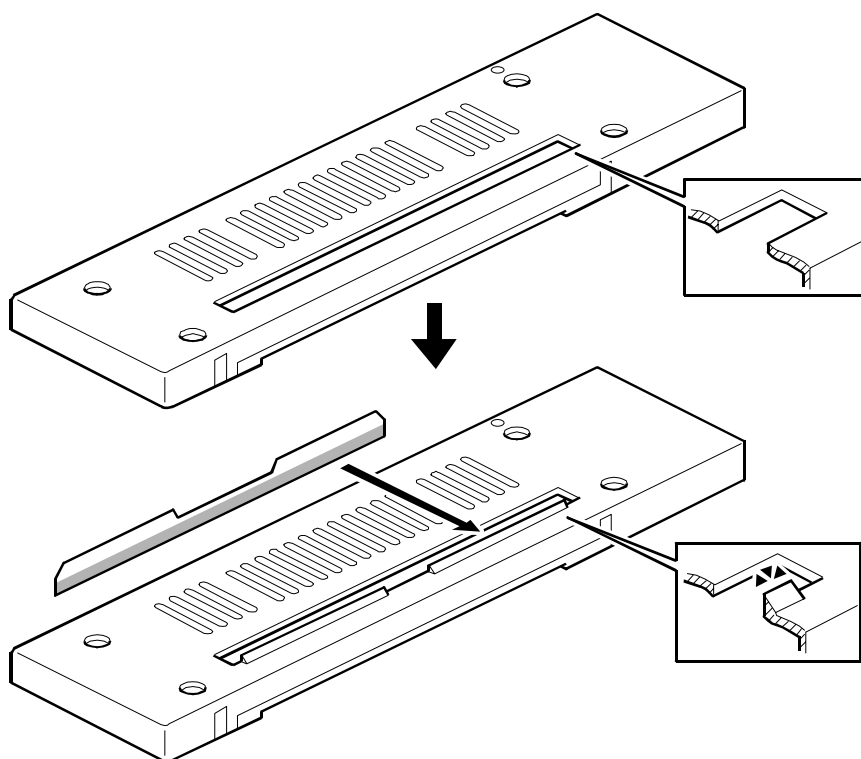

## RCL (Japan) Production

MODEL NAME	DESTINATION	CODE	SERIAL NO.
1 – BIN TRAY	USA, Canada, Europe, Asia	B376-17	H7811100001
1 – BIN TRAY	USA, Canada, Europe, Asia	B376-14	L0841110001
1 – BIN TRAY	USA, Canada, Europe, Asia	B376-26	4J71110001

Model: Adonics-C2 1bin Tray (PT1045)		Date: 25-Jul-02	No.: MB376003
Modified Article: Chromium Free		Prepared by: K. Takagi	
From: Technical Services sec. Service Planning Dept.			
Reason for Modification:	<input type="checkbox"/> Parts catalog correction <input type="checkbox"/> To facilitate assembly <input type="checkbox"/> Part standardization	<input type="checkbox"/> Vendor change <input type="checkbox"/> To improve reliability <input checked="" type="checkbox"/> Other	<input type="checkbox"/> To meet standards (        )

The following have been changed to chromium-free components to further minimize the impact on the environment.

Old part number	New part number	Description	Q'ty	Int.	Page	Index	Note
A6841111	B5441111	Side Plate - Front	1	O/O	5	32	
A6841112	B5441112	Transport Sensor Bracket	1	O/O	5	3	
A6841211	B5441211	Side Plate - Rear	1	O/O	5	31	
A6841212	B5441212	Safety Switch Bracket	1	O/O	5	10	
A6841213	B5441213	Sensor Bracket	1	O/O	5	29	
A6841214	B5441214	Main Board Bracket	1	O/O	3	26	
A6841311	B5441311	Upper Stay	1	O/O	5	9	
A6841401	B5441401	Base Assy	1	O/O	5	33	
A6841413	B5441413	Grounding Plate	1	O/O	3	20	
A6842332	B5442332	Pressure Release Bracket	1	O/O	5	14	
A6842511	B5442511	Motor Bracket	1	O/O	5	1	
A6843201	B5443201	Copy Tray Bracket	1	O/O	3	10	
B3761113	B5441113	Bracket - LED	1	O/O	5	7	

## RCL (Japan) Production

MODEL NAME	DESTINATION	CODE	SERIAL NO.
1 – BIN TRAY	USA, Canada, Europe, Asia	B376-17	H78208xxxxx
1 – BIN TRAY	USA, Canada, Europe, Asia	B376-14	L0842070034
1 – BIN TRAY	USA, Canada, Europe, Asia	B376-26	4J7082xxxx

Model: Adonis-C2 1 bin Tray (PT1045)		Date: 19-Sep-03	No.: MB376004
Modified Article: Main Board		Prepared by: Y.Urushihara	
From: 1st Tech. Support Sec. Service Support Dept.			
Reason for Modification:	<input type="checkbox"/> Parts catalog correction <input type="checkbox"/> To facilitate assembly <input type="checkbox"/> Part standardization	<input checked="" type="checkbox"/> Vendor change <input type="checkbox"/> To improve reliability <input type="checkbox"/> Other	<input type="checkbox"/> To meet standards (        )

The following has been changed due to a vendor change.

Old part number	New part number	Description	Q'ty	Int	Page	Index	Note
A6845100	B5445100	Main Board	1	O/O	3	25	

**RCL (Japan) Production**

MODEL NAME	DESTINATION	CODE	SERIAL NO.
1 – Bin Tray	USA, Canada, Europe, Asia	B376-14	L0842100001
1 – Bin Tray	USA, Canada, Europe, Asia	B376-17	H7820900722
1 – Bin Tray	USA, Canada, Europe, Asia	B376-26	4J71120001